

# BOOMBAG KIT

## #FightTheFloods

→ EQUIVALENT OF 12 SANDBAGS IN HERE, JUST ADD WATER!

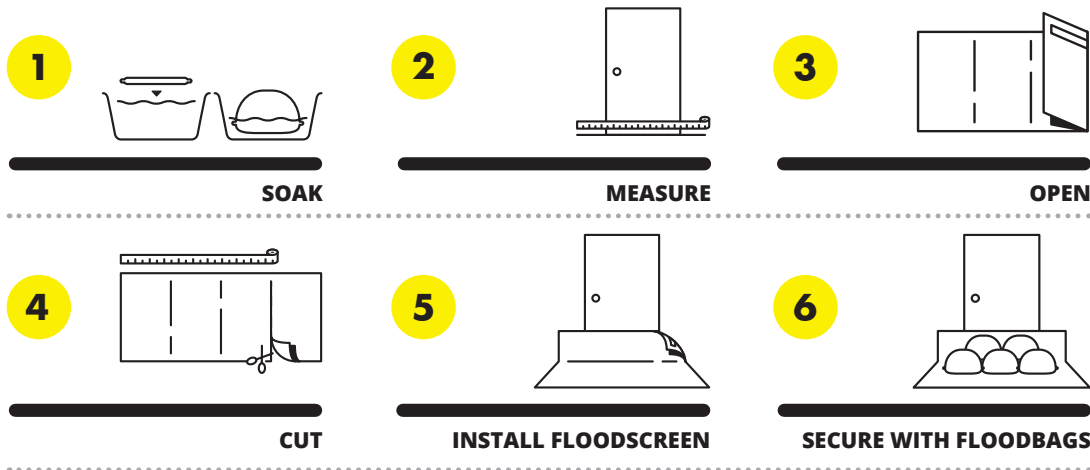

Our BoomBags™ are designed to stretch the length of a larger doorway with each section sized to match that of a standard sandbag. Our BoomBag™ Kit has the equivalent of 12 sandbags in just one kit. Apply the FloodScreen™ in front of your doorway, add water to inflate our FloodBags™ and in just minutes you've an impenetrable barrier

### → TECH SPECS



Employing a super absorbent polymer (SAP) our bags inflate in roughly 3 minutes when added to any liquid. They will then solidify and form to shape a regular sandbag.

<b>Length:</b>	135cm
<b>Width:</b>	27.5cm
<b>Absorption:</b>	20 litres in 3 mins
<b>Weight Before:</b>	360 gm
<b>Weight After:</b>	20kgs+
<b>Outer Fabric:</b>	100gm PE
<b>Internal Fabric:</b>	Sodium Polyacrylate (SAP)

### → PACKING SPECS



<b>BoomBags™ Kit:</b>	45 x 29.5 x 9 cm
<b>Master Case:</b>	48.5 x 32 x 37 cm (4 units per master)
<b>Cases per Pallet:</b>	36 (9x4 TI/HI)
<b>20'</b>	1,680 kits / 420 master cases
<b>40'</b>	3,520 kits / 880 master cases
<b>40'HC</b>	4,160 kits / 1,040 master cases
<b>UPC:</b>	085951300125
<b>GTIN:</b>	10859513001212

For pricing and additional info, please contact us:  
[www.fightthefloods.com](http://www.fightthefloods.com)



**FLOODAVERT**  
 Flood defence products

A division of

